

GENERAL NOTES

1.

ALL MATERIALS AND WORKMANSHIP SHALL CONFORM TO THE THESE DRAWINGS, GENERAL NOTES, AND TECHNICAL PROVISIONS, AS WELL AS THE CONSTRUCTION SPECIFICATIONS FOR THIS PROJECT PRESENTED IN BOOK FORM.
2.

THE CONTRACTOR SHALL BE RESPONSIBLE FOR MAINTAINING RECORD DRAWINGS FOR ALL WORK THROUGHOUT THE COURSE OF CONSTRUCTION. SUCH DRAWINGS SHALL RECORD THE LOCATION AND AS-BUILT CONDITION OF ALL PROJECT ELEMENTS. COPIES SHALL BE DELIVERED TO THE ENGINEER PRIOR TO THE ACCEPTANCE OF THE WORK, OR APPROVAL OF PAY APPLICATIONS, AS INDICATED IN THE SPECIFICATIONS
3.

THE CONTRACTOR SHALL EXAMINE THE DOCUMENTS AND SHALL NOTIFY THE ENGINEER OF ANY DISCREPANCIES WHICH MAY BE FOUND PRIOR TO THE START OF WORK.
4.

DETAILS MARKED "TYPICAL" SHALL APPLY IN ALL CASES, UNLESS NOTED OTHERWISE.
5.

FOR CONDITIONS DEVIATING FROM THE TYPICAL AND NOT SPECIFICALLY DETAILED IN THE PLANS, THE CONTRACTOR SHALL VERIFY CONSTRUCTION DETAILS WITH THE ENGINEER PRIOR TO CONSTRUCTION.
6.

DETAILS AND DIMENSIONS OF EXISTING CONDITIONS AS SHOWN ON THESE DRAWINGS ARE FOR REFERENCE ONLY. THE CONTRACTOR SHALL FIELD VERIFY AND RESOLVE ANY CONFLICTS WITH THE ENGINEER.
7.

THE CONTRACTOR SHALL BE RESPONSIBLE FOR COORDINATING THE WORK OF ALL TRADES AND SUBCONTRACTORS UNDER THE CONTRACTOR'S JURISDICTION.
8.

THE ALIGNMENT SHOWN ON THE DRAWINGS IS THE CONSTRUCTION REFERENCE LINE FOR THE PROJECT FACILITIES SHOWN. THE CONTRACTOR SHALL ESTABLISH THE ALIGNMENT AND ANY OFFSETS REQUIRED UTILIZING THE MONUMENTS PROVIDED.
9.

THE CONTRACTOR IS RESPONSIBLE FOR THE PROTECTION OF ALL EXISTING MONUMENTS AND OTHER SURVEY MARKERS. MONUMENTS AND SURVEY MARKERS DESTROYED DURING CONSTRUCTION SHALL BE REPLACED BY A LICENSED LAND SURVEYOR AT THE CONTRACTOR'S EXPENSE. CONTRACTOR SHALL PROVIDE ENGINEER WITH AT LEAST 48 HOURS ADVANCE NOTICE PRIOR TO REPLACEMENT.
10.

THE CONTRACTOR SHALL BE RESPONSIBLE FOR COMPLIANCE WITH ALL FEDERAL, STATE AND LOCAL LAWS, RULES AND REGULATIONS APPLICABLE TO ALL WORK PERFORMED UNDER THE CONTRACT.
11.

THE CONTRACTOR SHALL NOT BEGIN ANY WORK SHOWN ON THESE PLANS UNTIL ALL APPLICABLE PERMITS HAVE BEEN OBTAINED.
12.

THE CONTRACTOR IS RESPONSIBLE FOR COMPLIANCE WITH ALL CURRENT AND APPLICABLE SAFETY LAWS OF ALL JURISDICTIONAL BODIES. THE CONTRACTOR IS DIRECTED TO CONTACT THE OFFICE OF SAFETY AND HEALTH ADMINISTRATION (OSHA).
13.

INFORMATION CONTAINED WITHIN THESE DOCUMENTS SHALL NOT BE CONSTRUED TO PERMIT WORK NOT CONFORMING TO THE REFERENCED CODES.
14.

FOR ALL TRENCH EXCAVATIONS THAT ARE 5 FEET OR MORE IN DEPTH, THE CONTRACTOR SHALL OBTAIN A PERMIT FROM THE DIVISION OF INDUSTRIAL SAFETY. PRIOR TO BEGINNING ANY EXCAVATION, A COPY OF THIS PERMIT SHALL BE MADE AVAILABLE AND BE LOCATED ON THE CONSTRUCTION SITE AT ALL TIMES.
15.

THE CONTRACTOR SHALL PREPARE A TRAFFIC CONTROL PLAN DESCRIBING METHODS TO SAFELY CONTROL TRAFFIC ON PUBLIC ROADWAYS IN AND AROUND THE SITE.
16.

THE CONTRACTOR SHALL BE SOLELY AND COMPLETELY RESPONSIBLE FOR FURNISHING AND MAINTAINING ALL WARNING SIGNS, DEVICES, AND FEATURES NECESSARY TO PROTECT THE HEALTH AND SAFETY OF THE GENERAL PUBLIC AND WORKERS AND TO PROVIDE FOR THE PROPER AND SAFE ROUTING OF VEHICULAR AND PEDESTRIAN TRAFFIC DURING THE PERFORMANCE OF THE WORK.
17.

THE CONTRACTOR SHALL PROTECT FROM DAMAGE ALL EXISTING FACILITIES. ANY ITEMS DAMAGED BY THE CONTRACTOR OR HIS AGENTS SHALL BE REPLACED IN EQUAL OR BETTER CONDITION AS APPROVED BY THE OWNER'S REPRESENTATIVE.
18.

THE CONTRACTOR SHALL VERIFY ALL DIMENSIONS, SIZES AND LOCATIONS OF ALL EXISTING FACILITIES, UNDERGROUND UTILITIES, AND FEATURES TO REMAIN BEFORE STARTING WORK AND SHALL IMMEDIATELY NOTIFY THE ENGINEER OF ANY DISCREPANCIES.
19.

UTILITY INFORMATION WAS COMPILED FROM DATA PROVIDED BY THE UTILITY OWNERS AND LOCATIONS ARE APPROXIMATE. THE APPROXIMATE LOCATIONS AND ELEVATIONS OF THE EXISTING UTILITIES SHALL BE VERIFIED BY THE CONTRACTOR. IF RELOCATION IS REQUIRED, THE CONTRACTOR IS RESPONSIBLE FOR COORDINATING WITH THE APPROPRIATE UTILITY OWNER AT NO ADDITIONAL COST TO THE OWNER.
20.

THE CONTRACTOR IS TO REQUEST TO HAVE ALL UNDERGROUND UTILITIES THAT MAY POSSIBLY CONFLICT WITH THE ABOVE OR BELOW GROUND IMPROVEMENTS, LOCATED IN THE FIELD. THE CONTRACTOR AND ANY SUBCONTRACTOR ARE REQUIRED TO NOTIFY THE USA NORTH 811, 48 HOURS IN ADVANCE OF PERFORMING ANY EXCAVATION.
21.

DRAWINGS SHOWN WITH AERIAL PHOTOS ARE PROVIDED FOR REFERENCE ONLY. ALL FACILITIES MAY NOT BE SHOWN ON PHOTOS. THE CONTRACTOR SHALL SATISFY THEMSELVES AS TO THE LOCATION OF EXISTING FACILITIES THAT MAY BE AFFECTED BY THE CONSTRUCTION.
22.

EXISTING GRADES AND CONDITIONS SHALL BE CONFORMED TO WHENEVER POSSIBLE. ANY ADJACENT OR OFF SITE AREAS DISTURBED BY THE CONTRACTOR'S OPERATIONS MUST BE RESTORED BY THE CONTRACTOR TO THE PRE DISTURBANCE CONDITION TO THE SATISFACTION OF THE ENGINEER AND OWNER'S

SURVEY NOTES

1.

SURVEY (TOPOGRAPHY AND FEATURES) IS BASED ON A COMBINED FIELD SURVEY PROVIDED BY PSOMAS, PERFORMED BETWEEN NOVEMBER 2020 AND FEBRUARY 2022 AND FIELD SURVEY BY MORROW LAND SURVEYING DATED FEBRUARY 2014.

THE HORIZONTAL DATUM OF THIS SURVEY IS THE NORTH AMERICAN DATUM OF 1983 (NAD83) (1991.35 EPOCH) BEING THE CALIFORNIA COORDINATE SYSTEM OF 1983 (CCS83) ZONE 2 (GRID SURFACE).

THE VERTICAL DATUM OF THIS SURVEY IS THE NORTH AMERICAN VERTICAL DATUM OF 1988 (NAVd88). CONVERSION TO NAVD88 = NGVD + 2.611'.

NGS BENCHMARK 15.623 (JT0204) ELEV: 18.08 (ADJUSTED TO NAVD88 DATUM)

BENCH MARK DISK STAMPED "15.623" LOCATED AT 38°14' 58.60" (N) 122° 02' 25.08" (W) AND SET VERTICALLY IN THE SOUTH GRANITE WALL OF THE OLD SOLANO COUNTY COURTHOUSE, NEAR THE SOUTHEAST CORNER OF THE BUILDING, 66 FEET EAST OF THE MAIN (TEXAS STREET) ENTRANCE, AND 1.6 FEET ABOVE THE GROUND.

2.

THE CONTRACTOR SHALL BE RESPONSIBLE FOR CONSTRUCTION STAKING LAYOUT. CONSTRUCTION STAKING SHALL BE PERFORMED UNDER THE DIRECTION OF A LICENSED PROFESSIONAL LAND SURVEYOR OR CIVIL ENGINEER.
- EARTHWORK
1.

THE CONTRACTOR SHALL NOT ADJUST GRADES ON THIS PLAN WITHOUT PRIOR WRITTEN APPROVAL OF THE ENGINEER.

2.

THE CONTRACTOR SHALL TAKE THE NECESSARY PRECAUTIONS REQUIRED TO PROTECT ADJACENT PROPERTIES DURING THE GRADING OPERATIONS.

3.

DURING CONSTRUCTION, THE CONTRACTOR SHALL PROPERLY GRADE ALL EXCAVATED SURFACES TO PROVIDE POSITIVE DRAINAGE AND PREVENT PONDING OF WATER. THE CONTRACTOR SHALL CONTROL SURFACE WATER TO AVOID DAMAGE TO ADJOINING PROPERTIES OR TO FINISHED WORK ON THE SITE.

4.

WHEN IMPORTING OR EXPORTING OF ANY MATERIAL, THE CONTRACTOR SHALL MAINTAIN ALL PUBLIC ROADS USED AS A HAUL ROUTE SO THEY REMAIN DUST FREE

5.

ALL CUT OR FILL SLOPES SHALL BE 3:1 OR FLATTER UNLESS OTHERWISE NOTED.

6.

IMPLEMENT MEASURES TO PROTECT EXISTING STRUCTURES THAT ARE TO REMAIN FROM OVERLOAD OR DAMAGE. REPAIR OR RECONSTRUCT ANY DAMAGED FACILITIES AS DIRECTED BY THE OWNER AND OWNER'S REPRESENTATIVE.

7.

EXCAVATION SUPPORT: EXCAVATIONS FOR STRUCTURE AND TRENCHES SHALL BE SUPPORTED IN ACCORDANCE WITH THE REQUIREMENTS SPECIFIED IN 29CFR1926, SUBPART C - EXCAVATIONS; CAL/OSHA REQUIREMENTS, AND THE GENERAL CONDITIONS. TO PREVENT CAVING, SLIDING, AND SETTLEMENT, PROVIDE AN ENGINEERED SOLUTION, STAMPED BY A CALIFORNIA REGISTERED ENGINEER, FOR CONDITIONS BEYOND STANDARD SAFETY ORDERS AND PERMITTED TYPICAL EXCAVATION.

8.

THE CONTRACTOR IS RESPONSIBLE FOR THE SAFETY OF ALL TEMPORARY EXCAVATIONS AND MUST PROVIDE TRENCH SLOPING AND/OR SHORING IN ACCORDANCE WITH CURRENT CAL/OSHA REQUIREMENTS BASED ON EXPOSED SOIL AND GROUNDWATER/SEEPAGE CONDITIONS. FACTORS THAT MAY AFFECT EXCAVATION WALL STABILITY OR CAUSE EXCAVATION-RELATED DAMAGE TO EXISTING FACILITIES AND IMPROVEMENTS (SUCH AS CONSTRUCTION VIBRATIONS AND GROUNDWATER/SEEPAGE CONDITIONS) MUST BE EVALUATED AT THE TIME OF CONSTRUCTION, AND THE CONSTRUCTOR MUST ADJUST EXCAVATION SLOPING OR SHORING METHODS ACCORDINGLY.

9.

THE CONTRACTOR IS RESPONSIBLE FOR SUBMITTING AND OBTAINING APPROVAL FOR DEWATERING PLAN AND EXCAVATION AND SHORING PLAN PRIOR TO COMMENCING WORK.
- UTILITY TRENCH EXCAVATION AND BACKFILL
1.

EXCAVATIONS SHALL BE CONSTRUCTED IN ACCORDANCE WITH THE CURRENT CAL-OSHA SAFETY STANDARDS AND LOCAL JURISDICTION. THE STABILITY AND SAFETY OF EXCAVATIONS, BRACED OR UN-BRACED, ARE THE RESPONSIBILITY OF THE CONTRACTOR

2.

TRENCH EXCAVATIONS ADJACENT TO EXISTING OR PROPOSED FOUNDATIONS ABOVE AN IMAGINARY PLANE HAVING AN INCLINATION OF 1.5 HORIZONTAL TO 1 VERTICAL BELOW THE BOTTOM EDGE OF THE FOUNDATIONS SHALL BE PROPERLY SHORED TO MAINTAIN SUPPORT OF EXISTING FACILITIES.
- EROSION AND SEDIMENT CONTROL NOTES
1.

THE CONTRACTOR SHALL PROVIDE EROSION, SEDIMENT, AND WATER POLLUTION CONTROL MEASURES IN ACCORDANCE WITH THE APPROVED STORM WATER POLLUTION PREVENTION PLAN (SWPPP).

2.

DUST CONTROL, EROSION CONTROL, AND SEDIMENT CONTROL MEASURES, INCLUDING STREET CLEANING AT WORK AREA ENTRANCES SHALL BE CONTINUOUSLY MAINTAINED.

3.

THE CONTRACTOR SHALL CONDUCT OPERATIONS OUTSIDE OF AREAS DESIGNATED TO BE PRESERVED OR PROTECTED ACCORDING TO THE PLANS.

4.

ALL CONSTRUCTION OF OFF-SITE AND ON-SITE IMPROVEMENTS SHALL ADHERE TO NPDES BEST MANAGEMENT PRACTICES TO PREVENT DELETERIOUS MATERIALS OR POLLUTANTS FROM ENTERING THE COUNTY AND CITY STORM DRAIN SYSTEMS.
- WATER SURFACE ELEVATION DESIGN CRITERIA
1.

DESIGN STORM USED TO COMPUTE THE DESIGN WATER SURFACE ELEVATION (WSEL) WAS THE MAXIMUM ELEVATION DURING THE DECEMBER 2005 STORM EVENT WHICH HAD A RAINFALL DEPTH OF 4.4 INCHES IN 12 HOURS.

2.

TOP OF BARRIER ELEVATION IS BASED ON COMPUTED MAX WSEL PLUS 1-FT MINIMUM FREEBOARD.
- PARKING AND SECURITY
1.

REFER TO VOLUME 2 FOR ON-SITE TRAFFIC CIRCULATION AND PARKING LOT IMPROVEMENTS.

2.

REFER TO VOLUME 2 FOR SECURITY UPGRADES FOR THE JUSTICE CENTER CAMPUS AND PARKING LOTS.
- SANITARY SEWER
1.

DESIGN IMPROVEMENTS TO THE SANITARY SEWER SYSTEM WILL BE PERFORMED UNDER A SEPARATE PROJECT, BY KSN, WHICH INCLUDES REROUTING MAIN LINES OFF COUNTY PROPERTY AND PRIVATIZING THE REMAINING INFRASTRUCTURE LOCATED ON COUNTY-OWNED LAND. THE VOLUME 1 ASSET PROTECTION AND VOLUME 2 PARKING AND SECURITY DESIGN AND DRAWINGS ASSUME THAT PRIVATIZATION OF THE SYSTEM ON COUNTY PROPERTY WILL BE COMPLETED PRIOR TO CONSTRUCTION.

2.

REFER TO SANITARY SEWER NOTES ON DRAWINGS C-242 FOR REQUIREMENTS THAT WILL APPLY IF OFFSITE SANITARY SEWER IMPROVEMENTS ARE NOT COMPLETED PRIOR TO CONSTRUCTION OF THE VOLUME 1 ASSET PROTECTION PROJECT. IF REQUIRED, TEMPORARY BYPASS SHALL CONFORM WITH ALL REQUIREMENTS SHOWN ON KSN DRAWING SS1.
- CODE REQUIREMENTS:
1.

ALL WORK SHALL COMPLY WITH THE LATEST CALIFORNIA EDITION OF THE BUILDING, ELECTRICAL, MECHANICAL & PLUMBING CODES. ADDITIONAL CODE REQUIREMENTS FOR STRUCTURAL WORK ARE SHOWN ON SHEET S-001. ADDITIONAL CODE REQUIREMENTS FOR ELECTRICAL WORK ARE SHOWN ON SHEET E-001.
- SHEET INDEX
- SHEET NUMBER SHEET TITLE
- Sheet Files: GENERAL
- | | |
|--------------------|--|
| G-001 | COVER SHEET |
| G-002 | GENERAL NOTES AND SHEET INDEX |
| G-003 | LEGENDS AND ABBREVIATIONS |
| G-041 | ALIGNMENTS |
| G-042 | ALIGNMENT TABLES |
| Sheet Files: CIVIL | |
| C-021 | EROSION & SEDIMENT CONTROL STAGING PLAN I |
| C-022 | EROSION & SEDIMENT CONTROL STAGING PLAN II |
| C-051 | PLAN - DEMOLITION |
| C-052 | PLAN - DEMOLITION |
| C-141 | SITE OVERVIEW |
| C-142 | SITE PLAN - NORTHWEST CORNER |
| C-143 | SITE PLAN - SOUTHWEST CORNER |
| C-144 | SITE PLAN - SOUTEAST CORNER |
| C-145 | SITE PLAN - NORTHEAST CORNER |
| C-151 | SITE PLAN - UTILITIES |
| C-152 | SITE PLAN - UTILITIES |
| C-201 | PLAN AND PROFILE - STORM PROTECTION ALIGNMENT |
| C-202 | PLAN AND PROFILE - STORM PROTECTION ALIGNMENT |
| C-203 | PLAN AND PROFILE - STORM PROTECTION ALIGNMENT |
| C-204 | PLAN AND PROFILE - STORM PROTECTION ALIGNMENT |
| C-205 | PLAN AND PROFILE - STORM PROTECTION ALIGNMENT |
| C-211 | PLAN AND PROFILE - WEST DELAWARE STREET RAMP |
| C-212 | PLAN AND PROFILE - EAST DELAWARE STREET RAMP |
| C-213 | PLAN AND PROFILE - WASHINGTON STREET RAMP |
| C-241 | ENLARGED PLAN - PLAZA |
| C-242 | ENLARGED PLAN - MEMORIAL AND MATERIALS USE AREAS |
| C-301 | TYPICAL SECTIONS - FLOOD PROTECTION ALIGNMENT |
| C-311 | TYPICAL SECTIONS - ROAD |
| C-312 | TYPICAL SECTIONS - ROAD |
| C-313 | TYPICAL SECTIONS - ROAD |
| C-411 | PLAN AND PROFILE - EXTERIOR STORM DRAINAGE |
| C-412 | PLAN AND PROFILE - EXTERIOR STORM DRAINAGE |
| C-501 | TYPICAL DETAILS - STORM GATES |
| C-502 | TYPICAL DETAILS - UTILITIES |
| C-503 | TYPICAL DETAILS - PAVEMENT |
| C-504 | TYPICAL DETAILS - ACCESSIBILITY |
| C-505 | TYPICAL DETAILS - VEHICLE BARRIER |
| C-511 | TYPICAL DETAILS - CITY DETAILS STREET |
| C-512 | TYPICAL DETAILS - CITY DETAILS UTILITY |
| CG-141 | GRADING PLAN - NORTHWEST BERM |
| CG-142 | GRADING PLAN - PLAZA |
| CG-143 | GRADING PLAN - MEMORIAL AREA |
| CG-144 | GRADING PLAN - RAMP |
| CG-145 | GRADING PLAN - MAINTENANCE BUILDING AREA |
| CG-146 | GRADING PLAN - SOUTHEAST CORNER |
- Sheet Files: STRUCTURAL
- | | |
|-------|---|
| S-001 | GENERAL STRUCTURAL NOTES |
| S-002 | STRUCTURAL SPECIAL INSPECTION TABLE AND NOTES |
| S-301 | STRUCTURAL - WALLS |
| S-302 | STRUCTURAL - RAMP WALLS |
| S-501 | STRUCTURAL - TYPICAL DETAILS |
| S-502 | STRUCTURAL - TYPICAL DETAILS |
| S-503 | STRUCTURAL - TYPICAL DETAILS |
| S-504 | STRUCTURAL - TYPICAL DETAILS |
| S-505 | STRUCTURAL - TYPICAL DETAILS |
| S-531 | STRUCTURAL - GATE FOUNDATIONS |
| S-551 | STRUCTURAL - PRE-CAST VAULTS |
| S-552 | STRUCTURAL - COLLECTION VAULT |
| S-553 | SPOILS AREA PLANS, SECTIONS, AND DETAILS |
- Sheet Files: MECHANICAL
- | | |
|-------|---|
| M-141 | PLAN - PUMP STATION AND STORM DRAINAGE VAULTS |
| M-142 | PLAN - COGENERATION PLANT STORM DRAINAGE LIFT STATION |
| M-301 | PLAN AND SECTIONS - PUMP STATION |
| M-311 | SECTIONS - INTERIOR AND EXTERIOR STORM DRAINAGE VAULTS |
| M-321 | SECTIONS - COGENERATION PLANT STORM DRAINAGE LIFT STATION |
| M-501 | ASSEMBLY - OUTLET PIPE |
- Sheet Files: ELECTRICAL
- | | |
|-------|----------------------------------|
| E-001 | ELECTRICAL SYMBOLS AND LEGENDS |
| E-002 | INSTRUMENT SYMBOLS AND LEGENDS |
| E-011 | SINGLE LINE DIAGRAM - NEW MCC |
| E-012 | SINGLE LINE DIAGRAM - COGEN DEMO |
| E-013 | SINGLE LINE DIAGRAM - COGEN NEW |
| E-021 | MCC LAYOUT AND SCHEDULE |
| E-022 | SOFT STARTER MCC |
| E-023 | TYPICAL CONTROLLER PLC |
| E-024 | BLOCK DIAGRAM |
- | |
|-------|
| E-111 |
| E-112 |
| E-113 |
| E-114 |
| E-115 |
| E-116 |
| E-117 |
| E-118 |
| E-211 |
| E-212 |
| E-213 |
| E-214 |
| E-501 |
| E-502 |
| L-100 |
| L-201 |
| L-202 |
| L-203 |
| L-204 |
| L-205 |
| L-301 |
| L-302 |
| L-303 |
| L-304 |
| L-305 |
| L-306 |
| L-307 |
| L-308 |
- | |
|---|
| POWER PLAN |
| ENLARGED POWER PLAN - PUMP STATION |
| ENLARGED POWER PLAN - CO-GEN INTERIOR |
| ENLARGED POWER PLAN - CO-GEN PUMP STATION |
| P&ID LIFT STATION |
| P&ID LIFT STATION 2 |
| P&ID LIFT STATION 3 |
| CONDUIT & CONDUCTOR SCHEDULE |
| PLAZA LIGHTING PLAN |
| PLAZA LIGHTING SCHEDULE |
| LIFT STATION LIGHTING PLAN |
| LIFT STATION LIGHTING SCHEDULE |
| DETAILS 1 |
| DETAILS 2 |
| SITE OVERVIEW |
| LANDSCAPE PLAN - NORTHEAST ENTRY |
| LANDSCAPE PLAN - NORTHWEST CORNER |
| LANDSCAPE PLAN - SOUTHWEST CORNER |
| PLANTING LEGEND, DETAILS, AND NOTES |
| LANDSCAPE DETAILS |
| IRRIGATION PLAN - NORTHEAST ENTRY |
| IRRIGATION PLAN - NORTHWEST CORNER |
| IRRIGATION PLAN - SOUTHWEST CORNER |
| IRRIGATION NOTES AND LEGEND |
| IRRIGATION DETAILS |
| IRRIGATION DETAILS |
| IRRIGATION DETAILS |
| WATER USE CALCULATIONS |
- Mead & Hunt
- Mead and Hunt, Inc.
180 Promenade Circle,
Suite 240
Sacramento, CA 95834
phone: 916-971-3961
meadhunt.com
-
- 02/23/2026
- These documents shall not be used for any purpose or project for which it is not intended. Mead & Hunt shall be indemnified by the client and held harmless and defended from all claims, damages, liabilities, losses, and expenses, including attorneys' fees and costs, arising out of such misuse or reuse of the documents. In addition, unauthorized reproduction of these documents, in part or as a whole, is prohibited.
- SOLANO COUNTY
DOWNTOWN FAIRFIELD JUSTICE CAMPUS
ASSET PROTECTION PROJECT
675 TEXAS STREET
FAIRFIELD, CA 94533
- ISSUED
09/29/2025 ISSUED FOR
CONSTRUCTION
- 1 02/23/2026 SANITARY SEWER
REVISION
- M&H NO.: 1943400-190824.01
- DATE: SEPTEMBER 29, 2025
- DESIGNED BY: JOH
- DRAWN BY: MWR
- CHECKED BY: SRS
- DO NOT SCALE DRAWINGS
- SHEET CONTENTS
- GENERAL NOTES AND
SHEET INDEX
- G-002
- VOLUME 1
- X:\1943400\190824_01\TECH\CAD\PHASE 3\G-003 LEGENDS.DWG
2/23/2026 11:13:43 AM

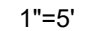

02/23/2026

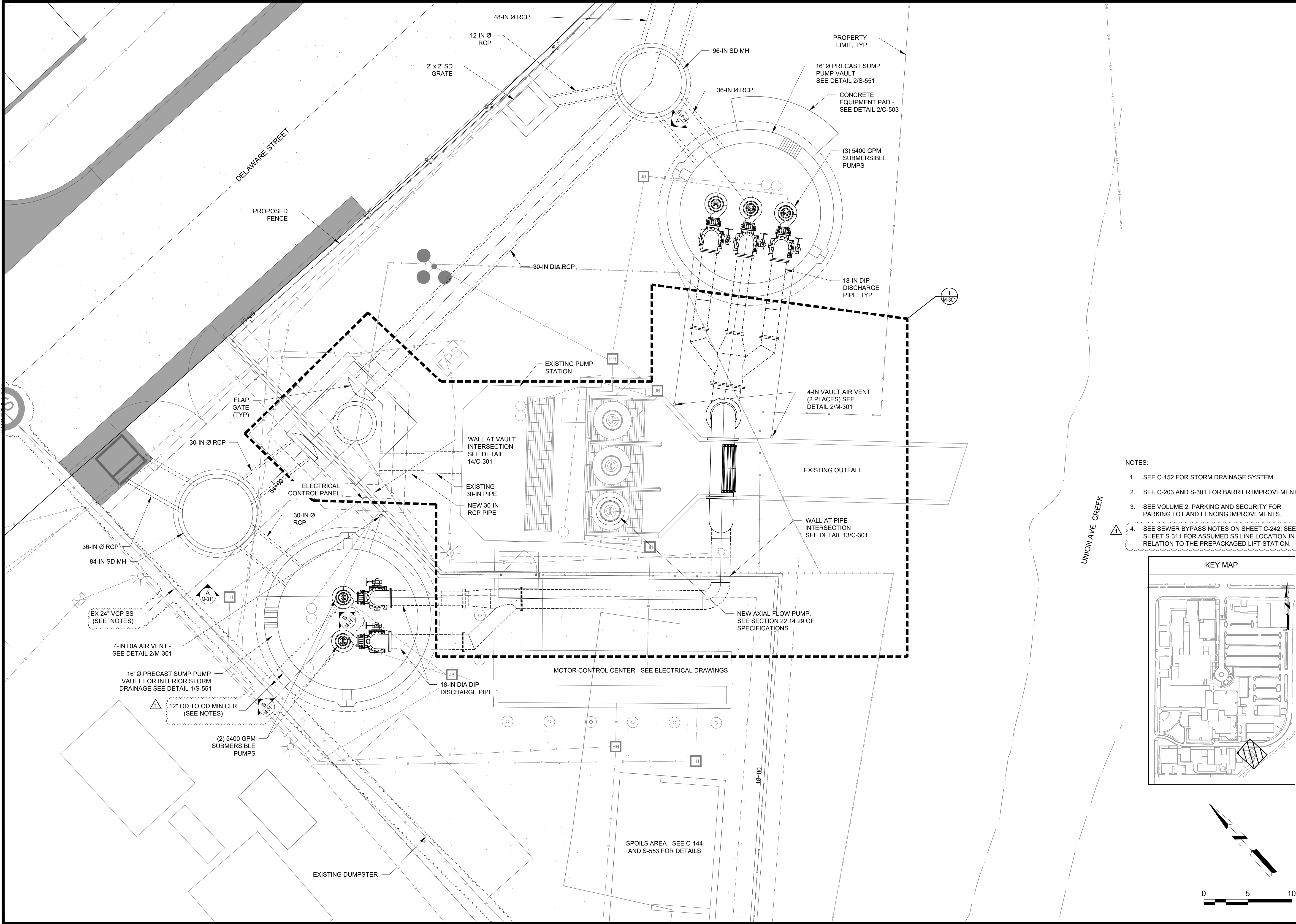

- NOTES:
- SEE C-152 FOR STORM DRAINAGE SYSTEM.
 - SEE C-203 AND S-301 FOR BARRIER IMPROVEMENTS.
 - SEE VOLUME 2: PARKING AND SECURITY FOR PARKING LOT AND FENCING IMPROVEMENTS.
 - SEE SEWER BYPASS NOTES ON SHEET C-242. SEE SHEET S-311 FOR ASSUMED SS LINE LOCATION IN RELATION TO THE PREPACKAGED LIFT STATION.

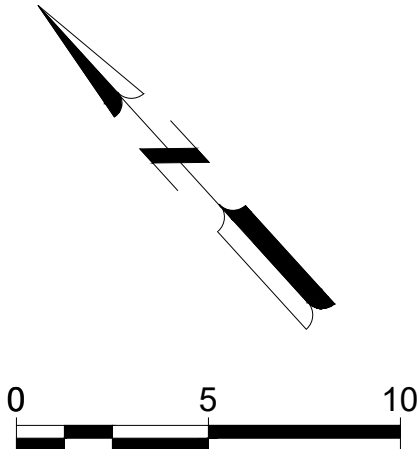
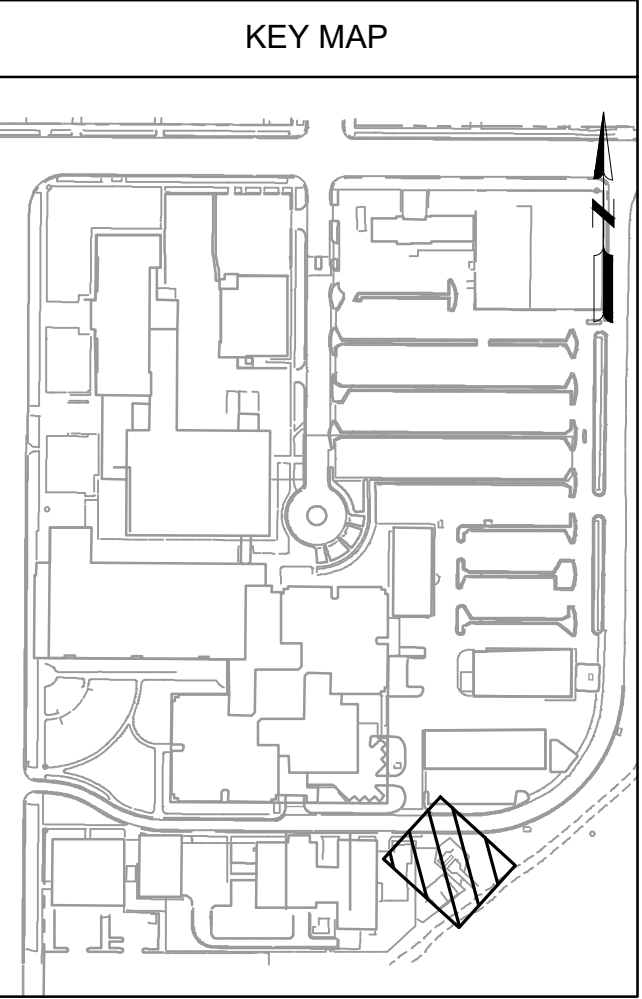

Mead & Hunt

Mead and Hunt, Inc.
180 Promenade Circle,
Suite 240
Sacramento, CA 95834
phone: 916-971-3961
meadhunt.com

02/23/2026

These documents shall not be used for any purpose or project for which it is not intended. Mead & Hunt shall be indemnified by the client and held harmless and defended from all claims, damages, liabilities, losses, and expenses, including attorneys' fees and costs, arising out of such misuse or reuse of the documents. In addition, unauthorized reproduction of these documents, in part or as a whole, is prohibited.

SOLANO COUNTY DOWNTOWN FAIRFIELD JUSTICE CAMPUS ASSET PROTECTION PROJECT

675 TEXAS STREET
FAIRFIELD, CA 94533

ISSUED
09/29/2025 ISSUED FOR CONSTRUCTION
1 02/23/2026 SANITARY SEWER REVISION

M&H NO.: 1943400-190824.01
DATE: SEPTEMBER 29, 2025
DESIGNED BY: TED
DRAWN BY: MWR
CHECKED BY: SRS
DO NOT SCALE DRAWINGS

SHEET CONTENTS
PLAN - PUMP STATION
AND STORM
DRAINAGE VAULTS

M-141

VOLUME 1

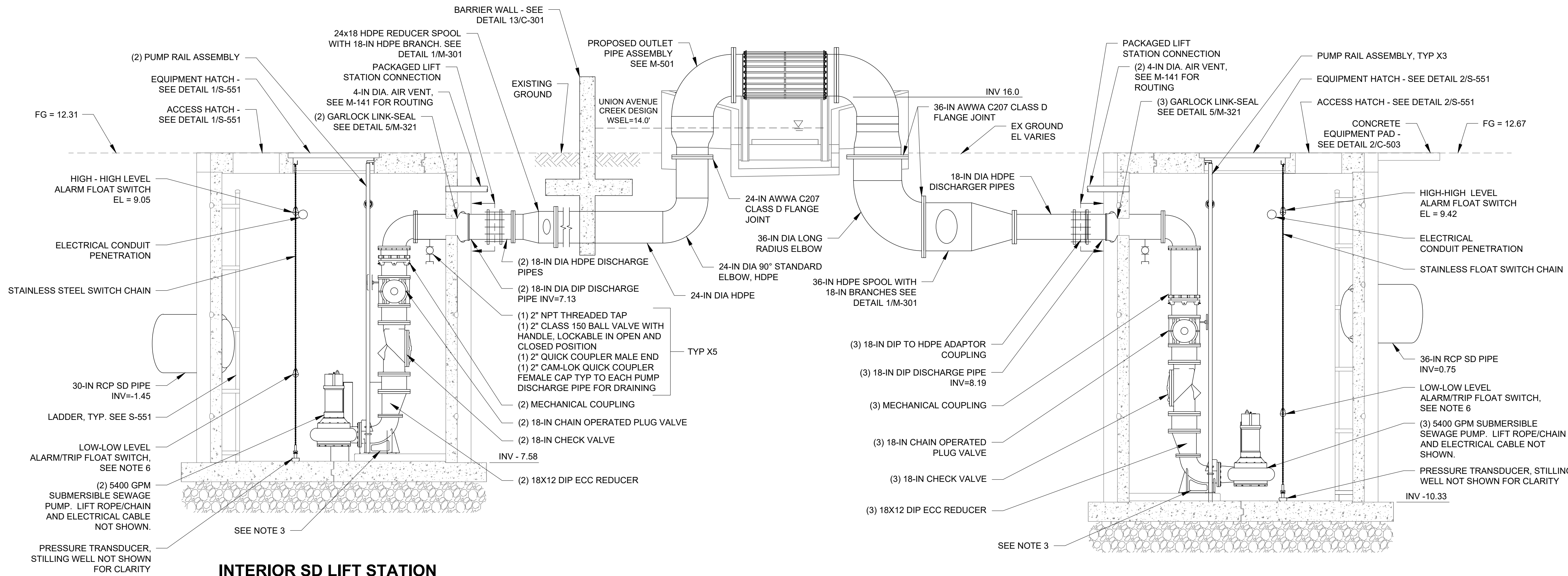

INTERIOR SD LIFT STATION

EXTERIOR SD LIFT STATION

INTERIOR & EXTERIOR DRAINAGE SUMPS
GENERAL ARRANGEMENT SCHEMATIC SECTION

A
M-141
3" = 1'

NOTES:

- LIFT STATION IS A PACKAGED SYSTEM TO BE SUBMITTED TO THE COUNTY FOR APPROVAL PRIOR TO PURCHASE. SEE SECTION 22 13 33 OF THE SPECIFICATIONS FOR ADDITIONAL REQUIREMENTS.
- PUMPS, DISCHARGE PIPING LINE-UP, AND GUIDE RAIL SYSTEM CONFIGURATIONS ARE APPROXIMATE AND SUBJECT TO CHANGE BASED ON CONTRACTOR SUBMITTAL.
- EQUIPMENT TO BE ANCHORED BY CHEMICAL (EPOXY) ANCHORS. ANCHORAGE DETAILS TO BE DESIGNED BY CONTRACTOR AND SUBMITTED TO THE COUNTY FOR REVIEW AND APPROVAL.
- SUMP DEPTH SUBJECT TO CHANGE BASED ON CONTRACTOR SUBMITTAL.
- PIPE SUPPORTS AND HANGERS TO BE DESIGNED AND STAMPED BY LICENSED PROFESSIONAL ENGINEER AND SUBMITTED BY THE CONTRACTOR TO THE COUNTY FOR REVIEW AND APPROVAL.
- LOW-LEVEL FLOAT SWITCH ELEVATION PER PUMP MANUFACTURERS RECOMMENDED MINIMUM SUBMERGENCE.
- CONTRACTOR SHALL VERIFY THE SS LOCATION PRIOR TO EXCAVATIONS AND VAULT CONSTRUCTION. BASED ON SS AS-BUILT INFORMATION, THE ESTIMATED CLEARANCE IS 1.19 FEET. CONTRACTOR SHALL FIELD VERIFY THE LOCATION OF THE EXISTING SS LINE AND ABILITY TO MAINTAIN MINIMUM CLEARANCE PRIOR TO ORDERING PREPACKAGED LIFT STATION. SEE SEWER BYPASS NOTES ON C-242.

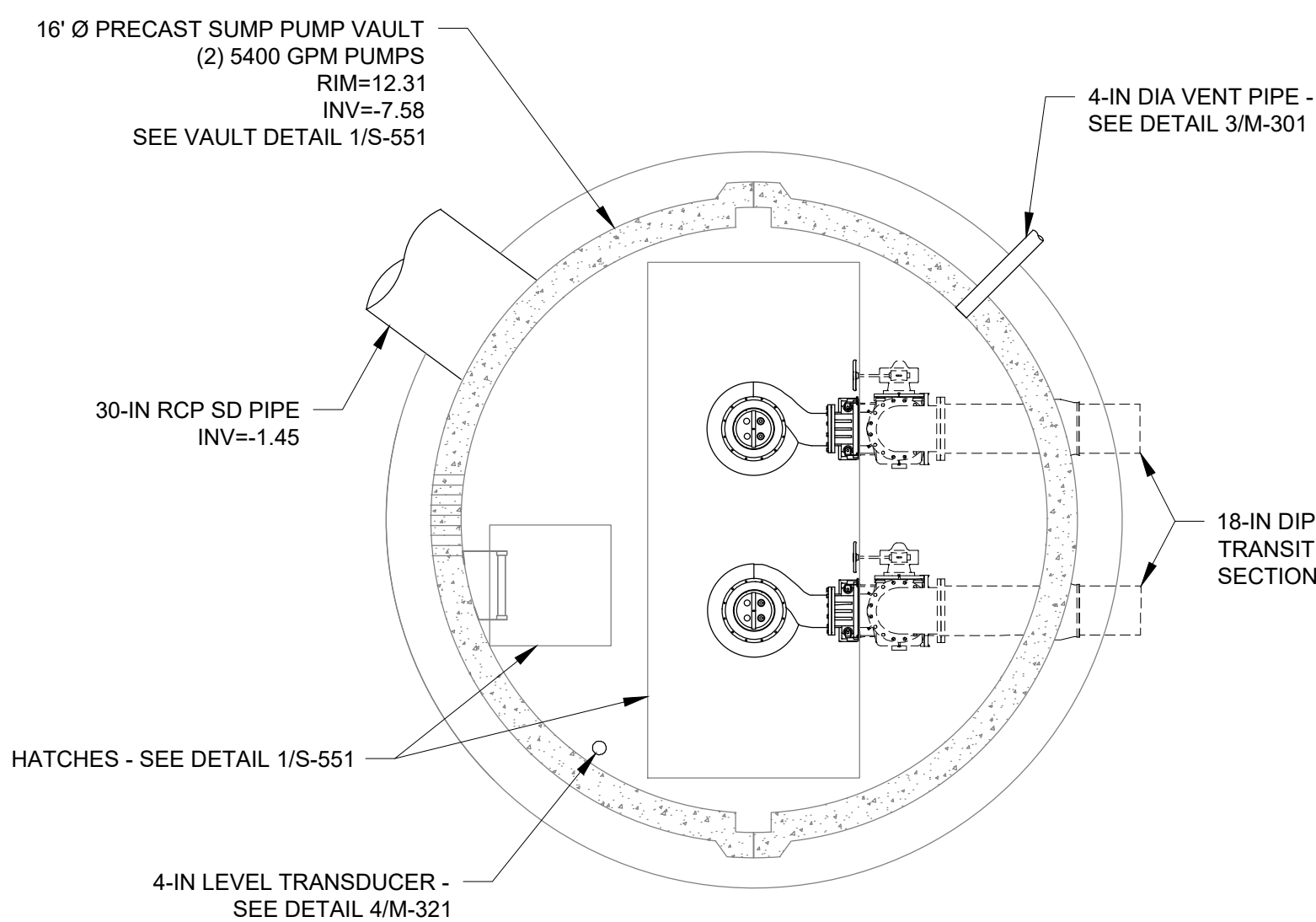

PLAN - INTERIOR SD LIFT STATION

3" = 1'

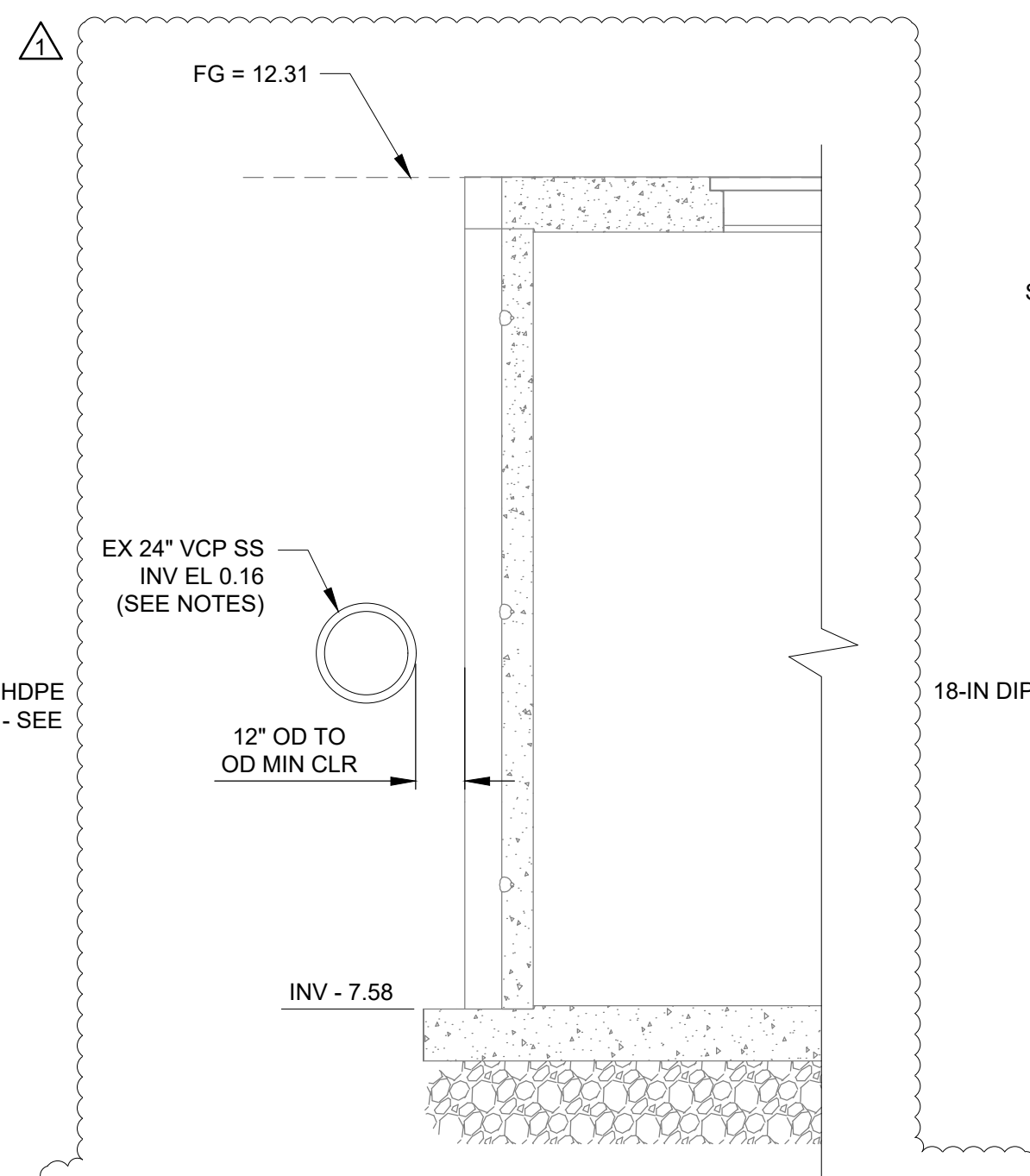

SECTION - INTERIOR SD LIFT STATION

B
M-141
3" = 1'

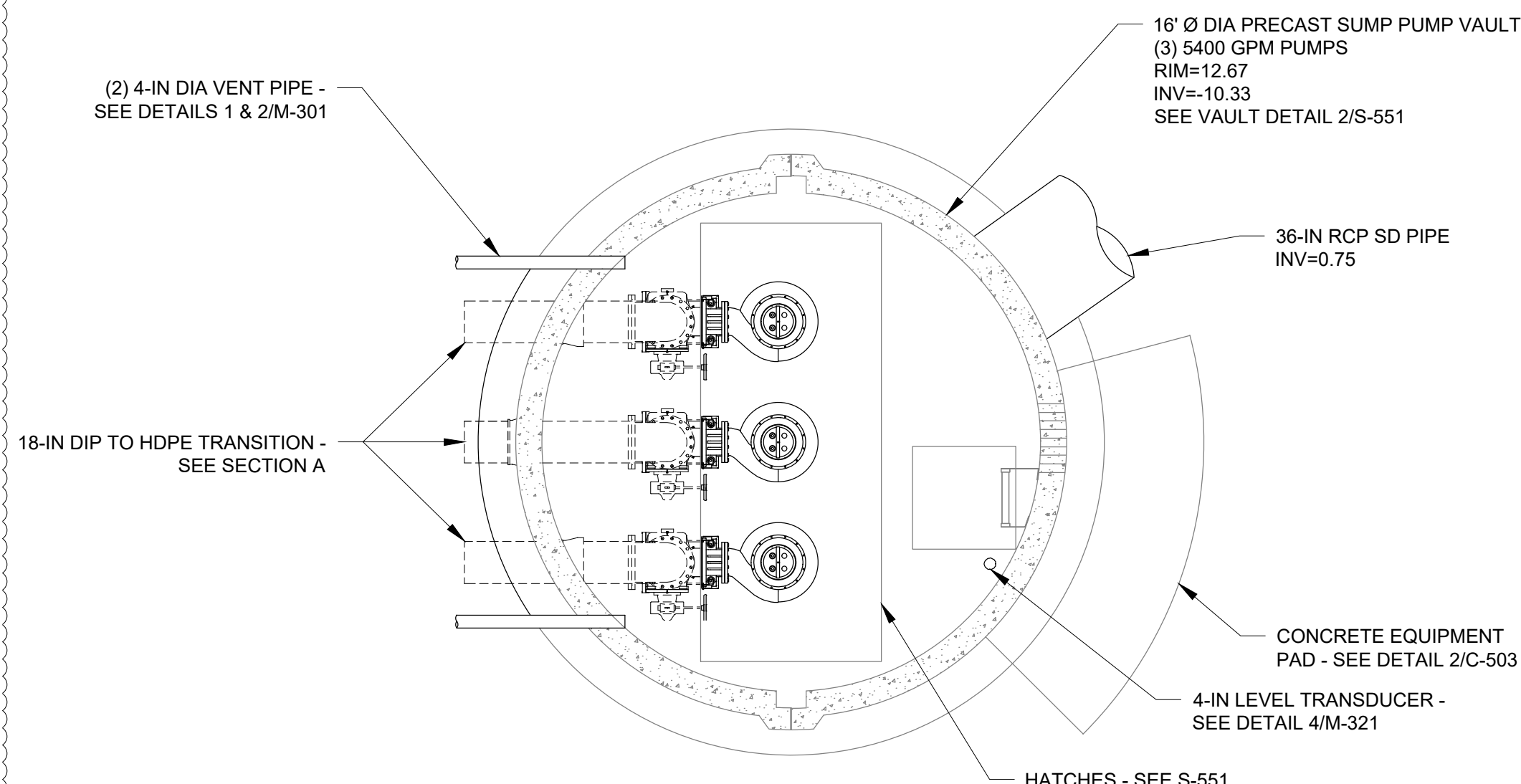

PLAN - EXTERIOR SD LIFT STATION

3" = 1'

Mead & Hunt
Mead and Hunt, Inc.
180 Promenade Circle,
Suite 240
Sacramento, CA 95834
phone: 916-971-3961
meadhunt.com

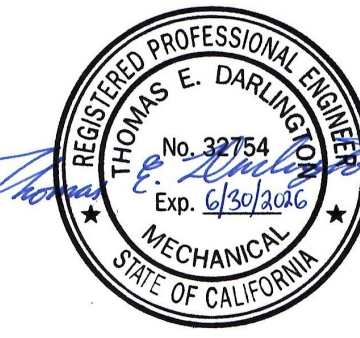

02/23/2026

These documents shall not be used for any purpose or project for which it is not intended. Mead & Hunt shall be indemnified by the client and hold harmless and defend from all claims, damages, liabilities, losses, and expenses, including attorneys' fees and costs, arising out of such misuse or reuse of the documents. In addition, unauthorized reproduction of these documents, in part or as a whole, is prohibited.

SOLANO COUNTY
DOWNTOWN FAIRFIELD JUSTICE CAMPUS
ASSET PROTECTION PROJECT
675 TEXAS STREET
FAIRFIELD, CA 94533

ISSUED
09/29/2025 ISSUED FOR CONSTRUCTION
1 02/23/2026 SANITARY SEWER REVISION

M&H NO.: 1943400-190824.01
DATE: SEPTEMBER 29, 2025
DESIGNED BY: TED
DRAWN BY: MWR
CHECKED BY: SRS
DO NOT SCALE DRAWINGS

SHEET CONTENTS
SECTIONS - INTERIOR
AND EXTERIOR
STORM DRAINAGE
VAULTS

M-311
VOLUME 1

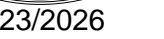

documents shall not be used for any purpose or for which it is not intended. Mead & Hunt shall be indemnified by the client and held harmless and released from all claims, damages, liabilities, losses, expenses, including attorneys' fees and costs, arising out of such misuse or reuse of the documents. In addition, unauthorized reproduction of these documents, in part or as a whole, is prohibited.

- NOTES:**
1. INTERCEPT EXISTING STANDBY 500KW GENERATOR CONDUIT AT ELECTRICAL BOX WHERE CONDUIT TRANSITIONS TO ABOVE GROUND. PULL CONDUCTORS ALL THE WAY BACK TO SALLY PORT GENERATOR.
 2. CONTRACTOR TO INSTALL NEW TERMINAL JUNCTION BOX AND ROUTE NEW CONDUIT AND CONDUCTORS TO NEW PUMP STATION MCC.
 3. INSTALL NEW CONDUCTORS IN EXISTING ABOVE GROUND CONDUIT TO EXISTING 500KW GENERATOR.
 4. CONTRACTOR TO FIELD ROUTE NEW LIFT STATION LIGHTING TO SPARE CIRCUIT BREAKER IN CO-GEN PANEL LP-3. CONTRACTOR TO FIELD ROUTE USING EXISTING CONDUIT AND WIRE WAYS WITHIN CO-GEN PLANT.
 5. CONTRACTOR TO AVOID PARALLEL RUNS OVER EXISTING UNDERGROUND UTILITY LINES WHEN ROUTING ELECTRICAL CONDUITS.



SOLANO COUNTY
DOWNTOWN FAIRFIELD JUSTICE CAMPUS
ASSET PROTECTION PROJECT

675 TEXAS STREET
FAIRFIELD, CA 94533

ISSUED
09/29/2025 ISSUED FOR
CONSTRUCTION
02/23/2026 SANITARY SEWER
REVISION

W&H NO.: 1943400-190824.01
 DATE: SEPTEMBER 29, 2025
 DESIGNED BY: JCB
 DRAWN BY: JCB
 CHECKED BY: RJT
 DO NOT SCALE DRAWINGS

POWER PLAN

E-111
VOLUME 1

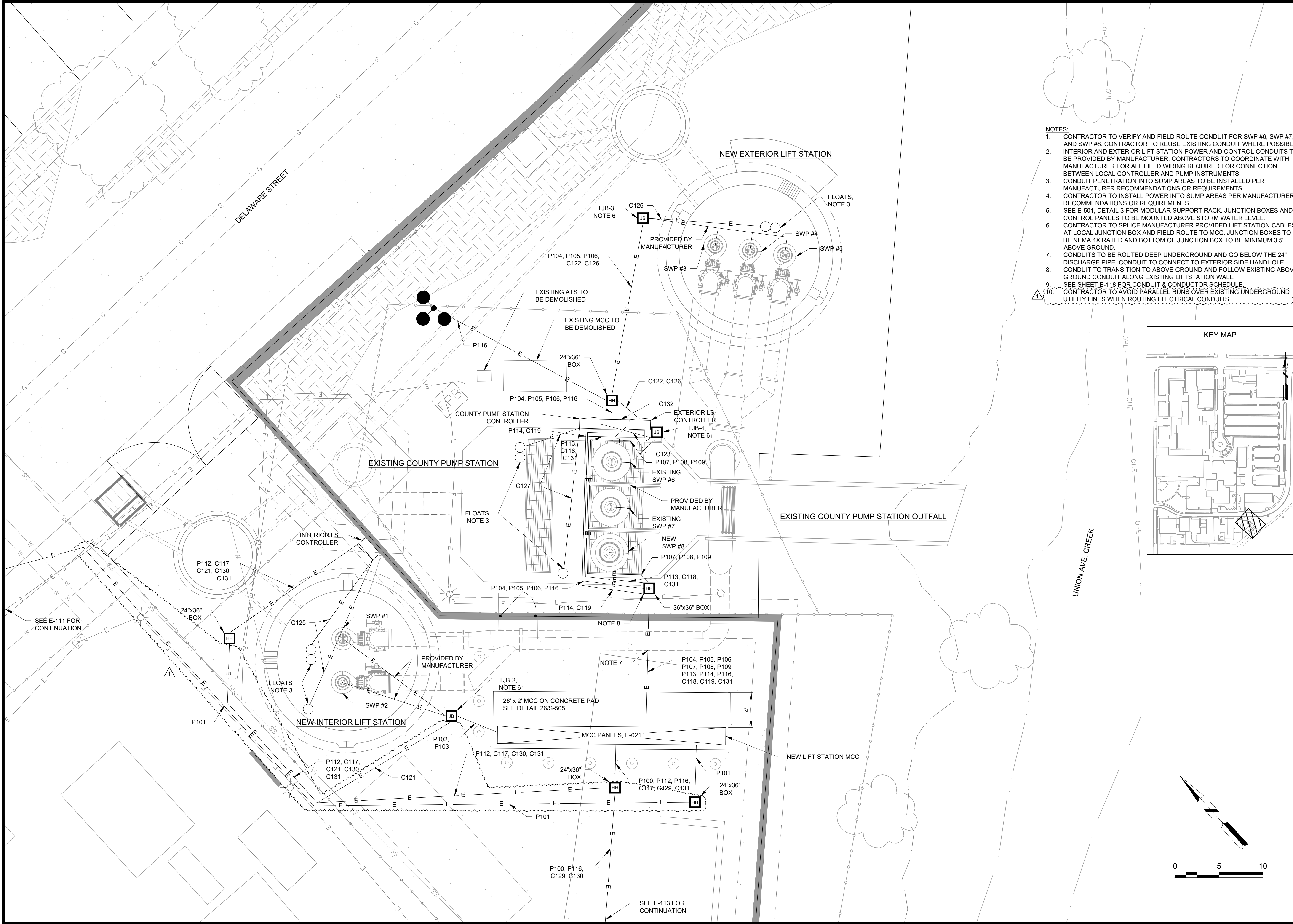

- NOTES:
1. CONTRACTOR TO VERIFY AND FIELD ROUTE CONDUIT FOR SWP #6, SWP #7, AND SWP #8. CONTRACTOR TO REUSE EXISTING CONDUIT WHERE POSSIBLE.
 2. INTERIOR AND EXTERIOR LIFT STATION POWER AND CONTROL CONDUITS TO BE PROVIDED BY MANUFACTURER. CONTRACTORS TO COORDINATE WITH MANUFACTURER FOR ALL FIELD WIRING REQUIRED FOR CONNECTION BETWEEN LOCAL CONTROLLER AND PUMP INSTRUMENTS.
 3. CONDUIT PENETRATION INTO SUMP AREAS TO BE INSTALLED PER MANUFACTURER RECOMMENDATIONS OR REQUIREMENTS.
 4. CONTRACTOR TO INSTALL POWER INTO SUMP AREAS PER MANUFACTURER RECOMMENDATIONS OR REQUIREMENTS.
 5. SEE E-501, DETAIL 3 FOR MODULAR SUPPORT RACK, JUNCTION BOXES AND CONTROL PANELS TO BE MOUNTED ABOVE STORM WATER LEVEL.
 6. CONTRACTOR TO SPLICE MANUFACTURER PROVIDED LIFT STATION CABLES AT LOCAL JUNCTION BOX AND FIELD ROUTE TO MCC. JUNCTION BOXES TO BE NEMA 4X RATED AND BOTTOM OF JUNCTION BOX TO BE MINIMUM 3.5' ABOVE GROUND.
 7. CONDUITS TO BE ROUTED DEEP UNDERGROUND AND GO BELOW THE 24" DISCHARGE PIPE. CONDUIT TO CONNECT TO EXTERIOR SIDE HANDHOLE. CONDUIT TO TRANSITION TO ABOVE GROUND AND FOLLOW EXISTING ABOVE GROUND CONDUIT ALONG EXISTING LIFTSTATION WALL.
 8. SEE SHEET E-118 FOR CONDUIT & CONDUCTOR SCHEDULE.
 9. CONTRACTOR TO AVOID PARALLEL RUNS OVER EXISTING UNDERGROUND UTILITY LINES WHEN ROUTING ELECTRICAL CONDUITS.

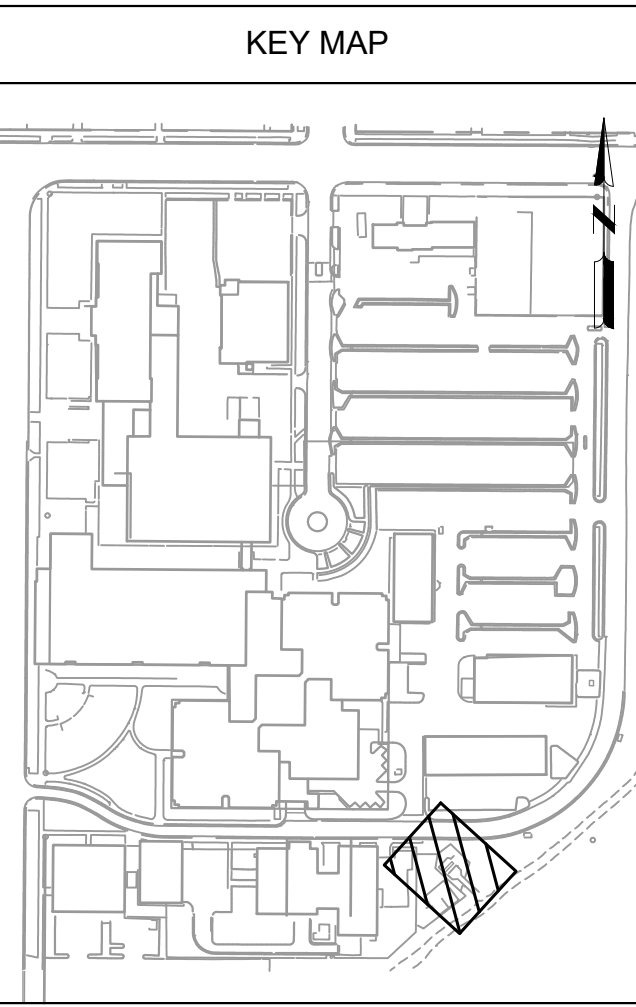

SOLANO COUNTY
DOWNTOWN FAIRFIELD JUSTICE CAMPUS
ASSET PROTECTION PROJECT
675 TEXAS STREET
FAIRFIELD, CA 94533

ISSUED
09/29/2025 ISSUED FOR CONSTRUCTION
1 02/23/2026 SANITARY SEWER REVISION

MSH NO.: 1943400-190824.01
DATE: SEPTEMBER 29, 2025
DESIGNED BY: JCB
DRAWN BY: JCB
CHECKED BY: RJT
DO NOT SCALE DRAWINGS

SHEET CONTENTS
ENLARGED POWER
PLAN - PUMP STATION

E-112
VOLUME 1

Mead & Hunt
Mead and Hunt, Inc.
180 Promenade Circle,
Suite 240
Sacramento, CA 95834
phone: 916-971-3961
meadhunt.com

REGISTERED PROFESSIONAL ENGINEER
Robert J. Thayer
E 12861
EXP. SEP 2027
ELECTRICAL
STATE OF CALIFORNIA
2/23/2026

These documents shall not be used for any purpose or project for which it is not intended. Mead & Hunt shall be indemnified by the client and held harmless and defended from all claims, damages, liabilities, losses, and expenses, including attorneys' fees and costs, arising out of such misuse or reuse of the documents. In addition, unauthorized reproduction of these documents, in part or as a whole, is prohibited.

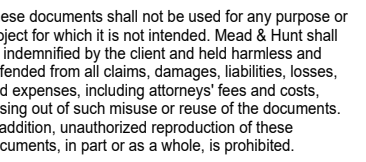

675 TEXAS STREET
FAIRFIELD, CA 94533

I&H NO.: 1943400-190824.01
 DATE: SEPTEMBER 29, 2025
 DESIGNED BY: JCB
 DRAWN BY: JCB
 CHECKED BY: RJT
 DO NOT SCALE DRAWINGS

E-113
VOLUME 1

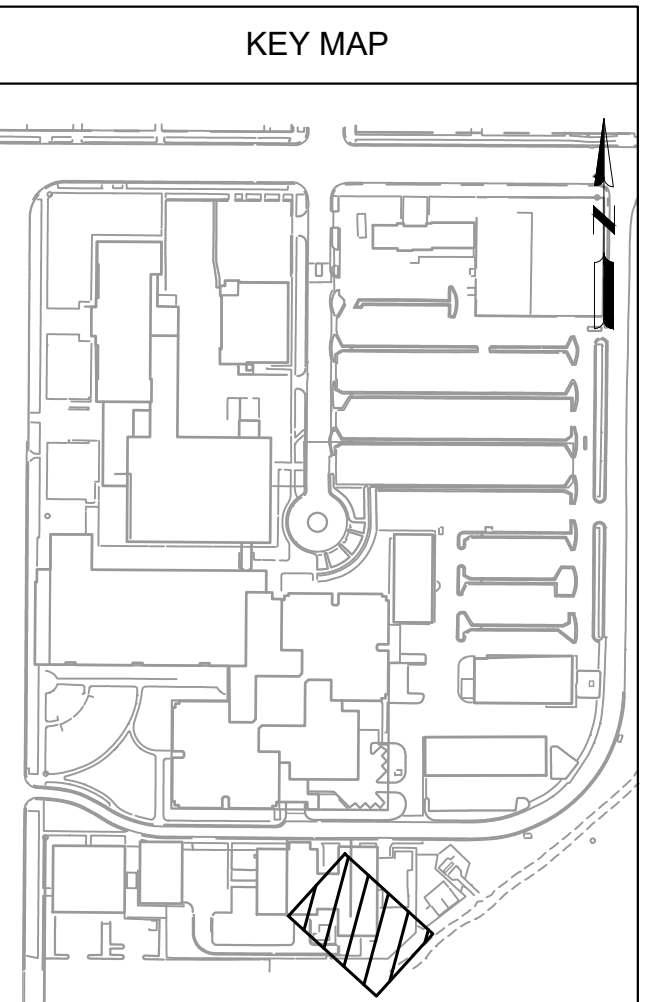

\\CORP.MEADHUNT.COM\SHARED\FOLDERS\ENTR19434001\90824.01\TECH\CAD\PHASE 3\E-114 ENLARGED POWER PLAN - CO-GEN PUMP STATION.DWG
2/23/2026 3:30:04 PM

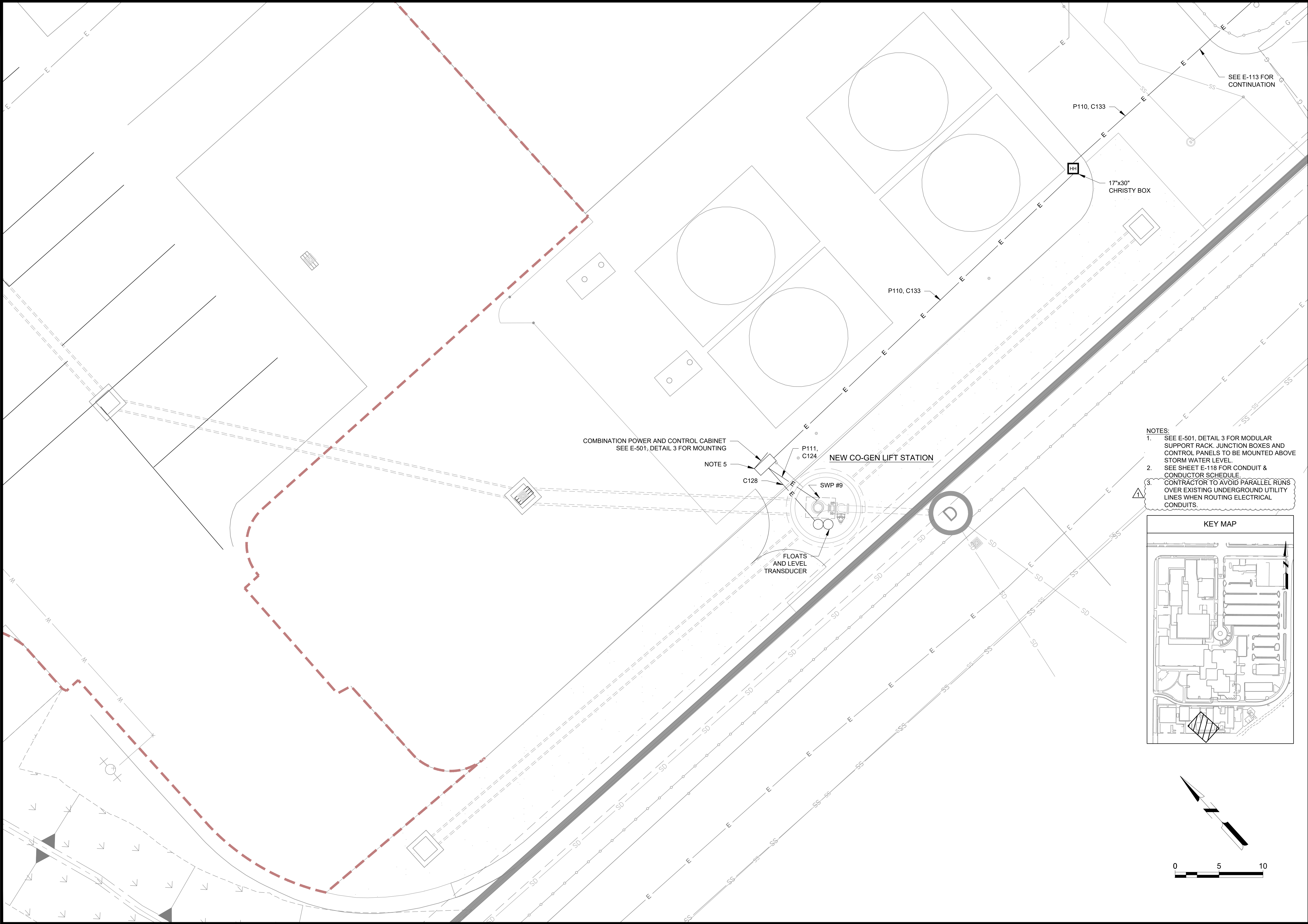

- NOTES:
1. SEE E-501, DETAIL 3 FOR MODULAR SUPPORT RACK, JUNCTION BOXES AND CONTROL PANELS TO BE MOUNTED ABOVE STORM WATER LEVEL.
 2. SEE SHEET E-118 FOR CONDUIT & CONDUCTOR SCHEDULE.
 3. CONTRACTOR TO AVOID PARALLEL RUNS OVER EXISTING UNDERGROUND UTILITY LINES WHEN ROUTING ELECTRICAL CONDUITS.

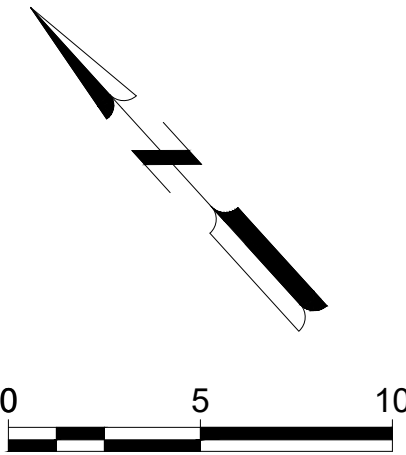
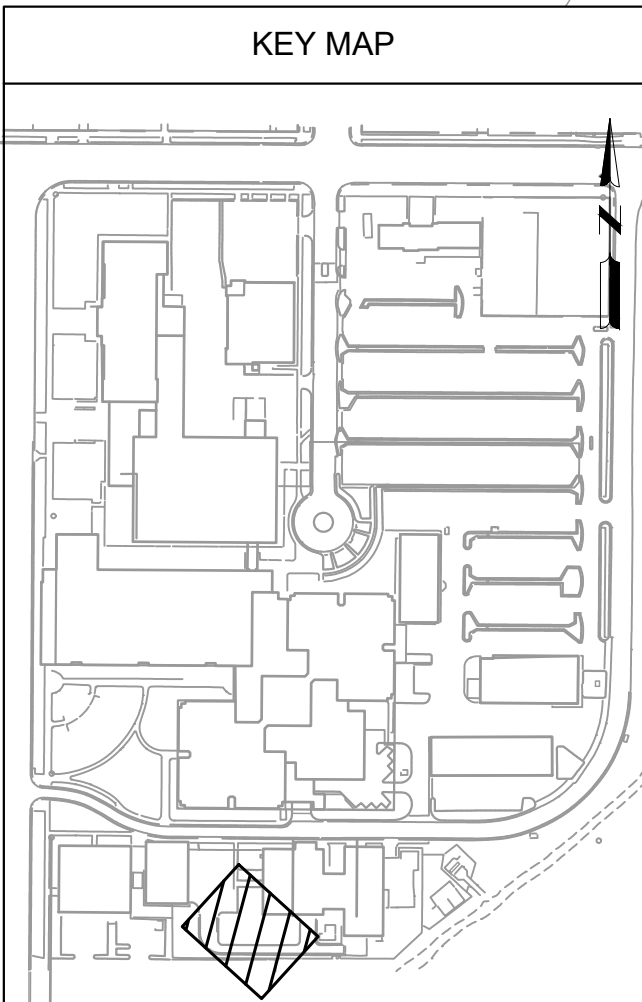

Mead & Hunt

Mead and Hunt, Inc.
180 Promenade Circle,
Suite 240
Sacramento, CA 95834
phone: 916-971-3961
meadhunt.com

2/23/2026

These documents shall not be used for any purpose or project for which it is not intended. Mead & Hunt shall be indemnified by the client and held harmless and defended from all claims, damages, liabilities, losses, and expenses, including attorneys' fees and costs, arising out of such misuse or reuse of the documents. In addition, unauthorized reproduction of these documents, in part or as a whole, is prohibited.

SOLANO COUNTY
DOWNTOWN FAIRFIELD JUSTICE CAMPUS
ASSET PROTECTION PROJECT

675 TEXAS STREET
FAIRFIELD, CA 94533

ISSUED
09/29/2025 ISSUED FOR CONSTRUCTION
1 02/23/2026 SANITARY SEWER REVISION

M&H NO.: 1943400-190824.01
DATE: SEPTEMBER 29, 2025
DESIGNED BY: JCB
DRAWN BY: JCB
CHECKED BY: RJT
DO NOT SCALE DRAWINGS

SHEET CONTENTS
ENLARGED POWER
PLAN - CO-GEN PUMP
STATION

\\CORP.MEADHUNT.COM\SHARED\FOLDERS\ENTR1943400\190824.01\TECH\AD\PHASE 3\E-214 LIFT STATION LIGHTING SCHEDULE.DWG
2/23/2026 3:39:07 PM

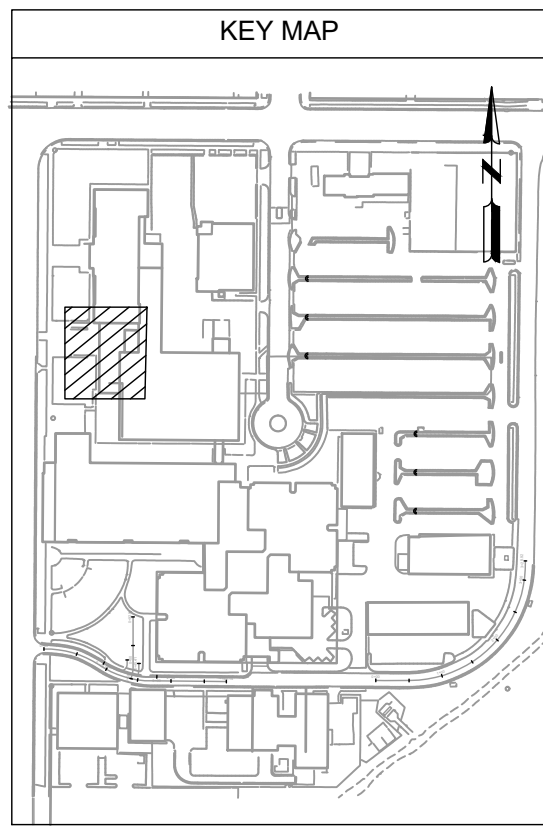
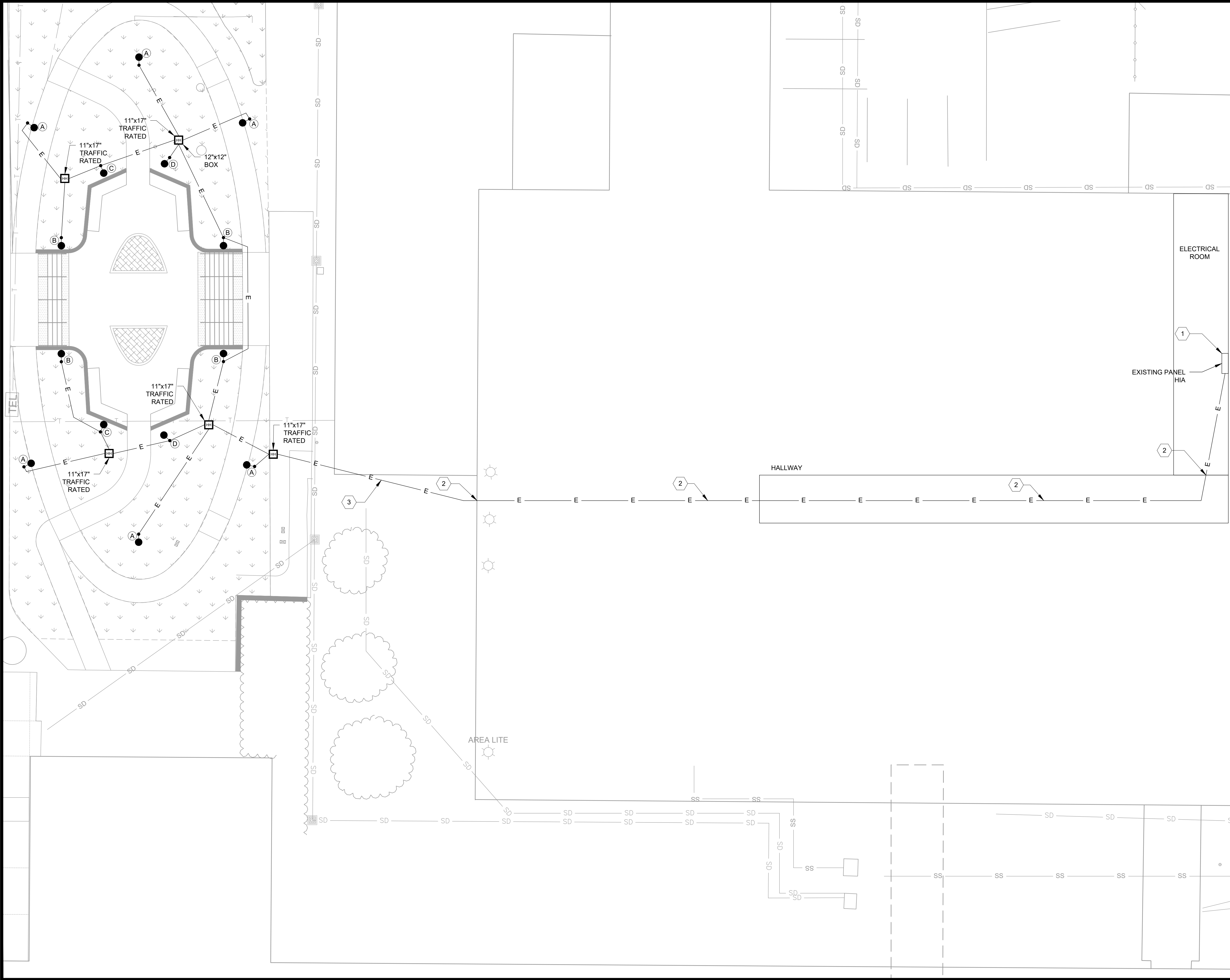

GENERAL ELECTRICAL NOTES

1. CONTRACTOR TO COORDINATE WITH COUNTY FOR EXACT ROUTING PATH.
2. CONTRACTOR TO INSTALL LIGHTING CONTROLS AND RELAY CONTACTS AS REQUIRED FOR NEW LIGHTS AND CONNECT TO BMS. CONTRACTOR TO COORDINATE WITH COUNTY FOR PROGRAMMING REQUIREMENTS.
3. LUMINAIRE CONDUIT SHALL BE 1" CONDUIT WITH ONE 10 AWG LIVE WIRE, ONE 10 AWG NEUTRAL WIRE, AND ONE 10 AWG GROUND WIRE.
4. SEE E-212 DETAIL 2 FOR LUMINAIRE SCHEDULE.
5. SEE DETAIL 5 ON SHEET E-501 FOR LIGHT POLE HEIGHT.
6. CONTRACTOR TO AVOID PARALLEL RUNS OVER EXISTING UNDERGROUND UTILITY LINES WHEN ROUTING ELECTRICAL CONDUITS.

KEY ELECTRICAL NOTES

1. CONTRACTOR TO INSTALL CONDUIT TO PANEL H1A AND NEW 20 AMP, 1 PHASE CIRCUIT BREAKER. CIRCUIT BREAKER SHALL MATCH EXISTING PANELBOARD MANUFACTURER, MODEL, & AIC RATING.
2. CONTRACTOR TO ROUTE CONDUIT FROM EXTERIOR WALL, DOWN THE HALLWAY AND TO ELECTRICAL ROOM. CONTRACTOR TO FIELD ROUTE CONDUIT CONCEALED AND ABOVE THE CEILING.
3. CONTRACTOR TO INSTALL CONDUIT UNDERGROUND TO COURTHOUSE EXTERIOR BUILDING. ROUTE CONDUIT UP EXTERIOR OF WALL TO CEILING HEIGHT AND PENETRATE. INSTALL WEATHER SEAL AROUND CONDUIT.

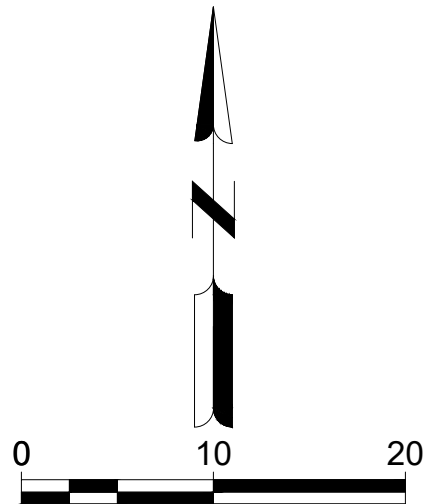

SOLANO COUNTY
DOWNTOWN FAIRFIELD JUSTICE CAMPUS
ASSET PROTECTION PROJECT
675 TEXAS STREET
FAIRFIELD, CA 94533

ISSUED
09/29/2025 ISSUED FOR CONSTRUCTION
1 02/23/2026 SANITARY SEWER REVISION

M&H NO.: 1943400-190824.01
DATE: SEPTEMBER 29, 2025
DESIGNED BY: JCB
DRAWN BY: JCB
CHECKED BY: RJT
DO NOT SCALE DRAWINGS

SHEET CONTENTS
PLAZA LIGHTING PLAN

E-211
VOLUME 1

Mead & Hunt

Mead and Hunt, Inc.
180 Promenade Circle,
Suite 240
Sacramento, CA 95834
phone: 916-971-3961
meadhunt.com



These documents shall not be used for any purpose or project for which it is not intended. Mead & Hunt shall be indemnified by the client and held harmless and defended from all claims, damages, liabilities, losses, and expenses, including attorneys' fees and costs, arising out of such misuse or reuse of the documents. In addition, unauthorized reproduction of these documents, in part or as a whole, is prohibited.

\\CORP.MEADHUNT.COM\SHARED\FOLDERS\ENTR19434001\90824.01\TECH\CAD\PHASE 3\E-214 LIFT STATION LIGHTING SCHEDULE.DWG
2/23/2026 3:35:05 PM

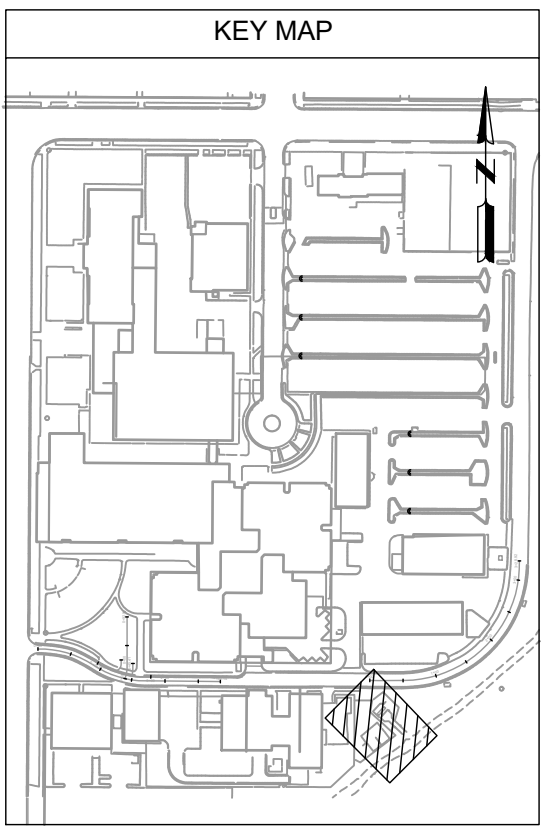
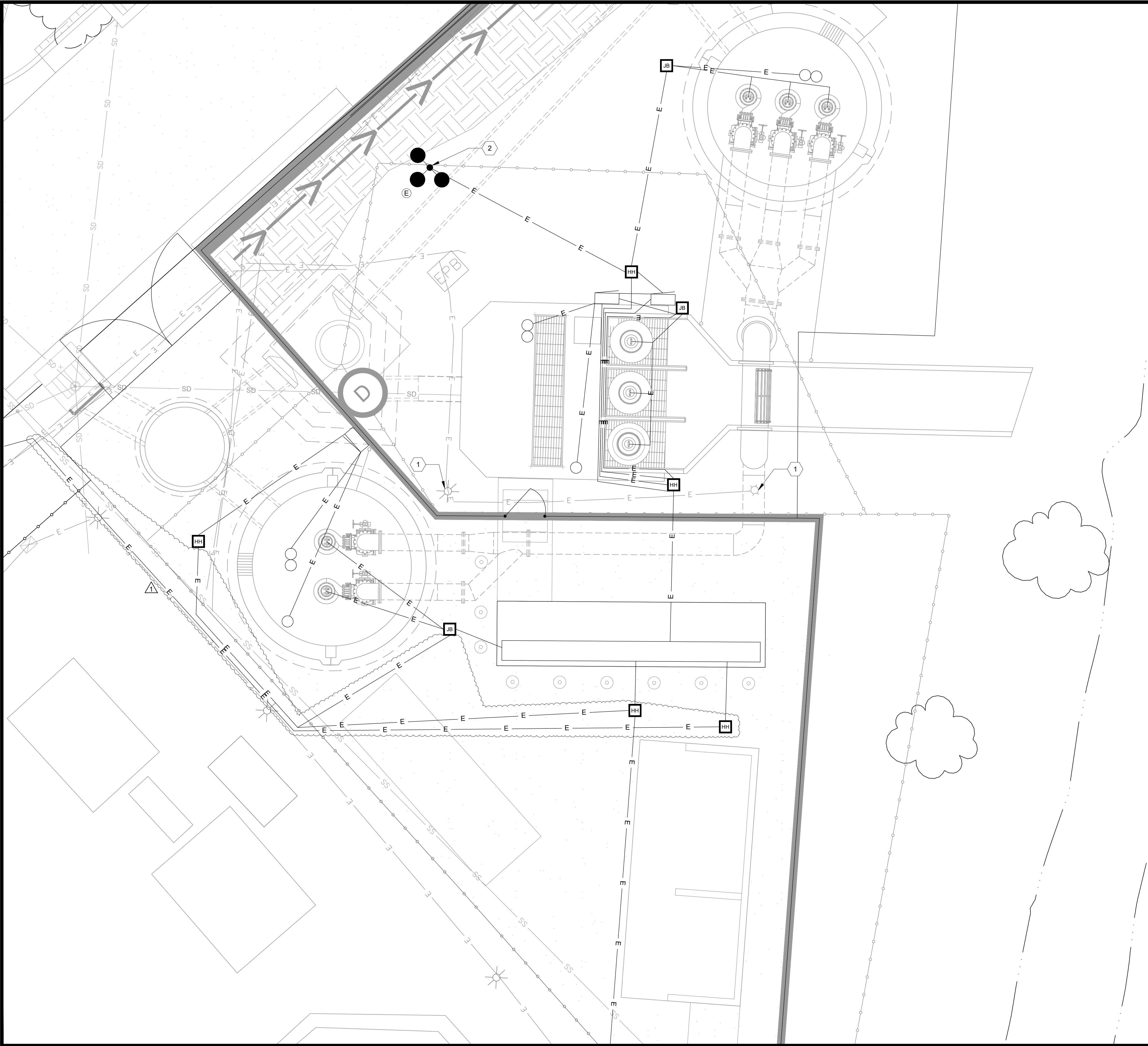

GENERAL ELECTRICAL NOTES

1. CONTRACTOR TO INSTALL CONDUIT FROM PANEL LP3 IN CO-GEN TO NEW LIFT STATION LIGHTING. CONTRACTOR TO INSTALL NEW 20 AMP/2POLE (208V-1PHASE) CIRCUIT BREAKER.
2. CONTRACTOR TO INSTALL LIGHTING CONTROLS AND RELAY CONTACTS AS REQUIRED FOR NEW LIGHTS AND CONNECT TO BMS. CONTRACTOR TO COORDINATE WITH COUNTY FOR PROGRAMMING REQUIREMENTS.
3. SEE E-111 & E-113 FOR CONDUIT ROUTING. CONTRACTOR TO COORDINATE WITH COUNTY FOR EXACT ROUTING PATH.
4. SEE E-118 FOR CONDUIT & CONDUCTOR SCHEDULE.
5. SEE E-214 DETAIL 2 FOR LUMINAIRE SCHEDULE.
6. SEE E-501 DETAIL 5 FOR LIGHT POLE.
7. CONTRACTOR TO AVOID PARALLEL RUNS OVER EXISTING UNDERGROUND UTILITY LINES WHEN ROUTING ELECTRICAL CONDUITS.

KEY ELECTRICAL NOTES

1. CONTRACTOR TO DEMOLISH EXISTING LIGHTS, CONDUCTORS, AND CONDUIT.
2. CONTRACTOR TO INSTALL NEW LIGHTS AND FIELD ROUTE CONDUIT BACK TO LP3 IN COGEN PLANT.

Mead & Hunt

Mead and Hunt, Inc.
180 Promenade Circle,
Suite 240
Sacramento, CA 95834
phone: 916-971-3961
meadhunt.com



These documents shall not be used for any purpose or project for which it is not intended. Mead & Hunt shall be indemnified by the client and held harmless and defended from all claims, damages, liabilities, losses, and expenses, including attorneys' fees and costs, arising out of such misuse or reuse of the documents. In addition, unauthorized reproduction of these documents, in part or as a whole, is prohibited.

SOLANO COUNTY
DOWNTOWN FAIRFIELD JUSTICE CAMPUS
ASSET PROTECTION PROJECT
675 TEXAS STREET
FAIRFIELD, CA 94533

ISSUED
09/29/2025 ISSUED FOR CONSTRUCTION
1 02/23/2026 SANITARY SEWER REVISION

M&H NO.: 1943400-190824.01
DATE: SEPTEMBER 29, 2025
DESIGNED BY: JCB
DRAWN BY: JCB
CHECKED BY: RJT
DO NOT SCALE DRAWINGS

SHEET CONTENTS
LIFT STATION
LIGHTING PLAN

E-213
VOLUME 1